





Series		P8S-G <sup>1)</sup> - insertable into T-Slot from top					
Type		M8R <sup>2)</sup>		FL <sup>3)</sup>		M8R <sup>2)</sup>	FL <sup>3)</sup>
							
<b>CE. cULus. RoHs</b>							
Output Function		0.3 m Cable	3 m Cable	10 m Cable	0.3 m Cable	3 m Cable	10 m Cable
PNP	NO	P8S-GPCHX	P8S-GPFAX	P8S-GPFDX			
	NC	P8S-GQCHX	P8S-GQFAX	P8S-GQFDX			
NPN	NO	P8S-GNCHX	P8S-GNFAX	P8S-GNFDX			
	NC	P8S-GMCHX	P8S-GMFAX	P8S-GMFDX			
REED	NO				P8S-GRCHX	P8S-GRFAX	P8S-GRFDX
	NC				P8S-GECNX	P8S-GEFFX	P8S-GEFRX
Technical Data		Electrical			Reed		
Electrical Characteristics							
Electric Configuration		3-pole			2-pole		
Indicator LED yellow		yes			yes (not NC)		
Operating Voltage U <sub>b</sub> [V]		10 - 30 DC			10 - 30 AC/DC		
Ripple of U <sub>b</sub> [%]		≤ 10			≤ 10		
Voltage Drop U <sub>a</sub> [V]		≤ 2			≤ 3		
Power Consumption <sup>4)</sup> [mA]		≤ 10					
Continuous Current I <sub>a</sub> [mA]		≤ 100			≤ 500 (NO ≤ 100)		
Max. Switching Capacity [W]		≤ 6			≤ 10		
Switchable Capacity Load @ 100W @ 24VDC [nF]					100		
Switching Frequency [Hz]		≤ 1,000			≤ 400		
Time delay before availability [ms]		0.5 / 0.5			1.5 / 0.5		
Sensitivity [mT]		2.8			3		
Hysteresis [mT]		0.7			≥ 0.2		
EMC <sup>6)</sup>		yes			yes		
Lifetime		unlimited			≥ 20*10 <sup>6</sup> Cycles		
Short Circuit Protection <sup>5)</sup>							
Reverse Polarity Protection		yes					
Power-Up Pulse Suppression							
Protection for Inductive Load							
ATEX Version		on request					
Mechanical Characteristics							
Housing		PA12					
Cable Type		PUR / black					
Cable Cross Section [mm <sup>2</sup> ]		Connector 3-pole	3 x 0.14	3 x 0.14	Connector 3-pole	2 x 0.14	2 x 0.14
Bending Radius Fixed Installation [mm]		≥ 30					
Bending Radius Moving [mm]		≥ 45					
Shock Resistance							
Protection <sup>7)</sup> [IP]		67					
Ambient Temperature Range T <sub>a</sub> [°C]		-25 ... +75					
Shock <sup>8)</sup> / Vibration <sup>9)</sup>		30 g, 11 ms / 10 to 55 Hz, 1 mm					

<sup>1)</sup> without OSP-E..STR

<sup>2)</sup> plug M8 with rotatable nut

<sup>3)</sup> Cable with Flying Leads

<sup>4)</sup> unloaded U<sub>b</sub> = 24V

<sup>5)</sup> clocked

<sup>6)</sup> to EN 60529

<sup>7)</sup> to EN 60529

<sup>8)</sup> to EN 60068-2-27

<sup>9)</sup> to EN 60068-2-6

## Switching function and electrical connection

Reed 2-pole

**normally open**

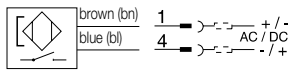

**normally closed**

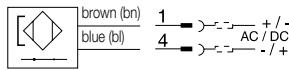

PNP 3-pole

**normally open**

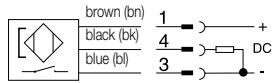

**normally closed**



NPN 3-pole

**normally open**

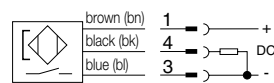

**normally closed**

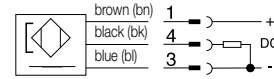

## Dimensions (mm) - Type P8S

Socket Screw - (SW\* 1.5 mm) / Slotted Screw

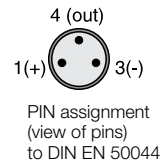
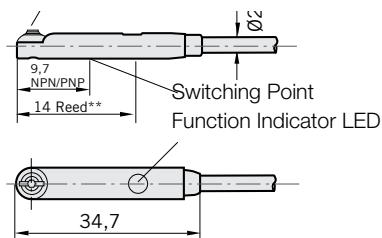
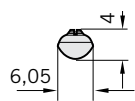

P8S-... cable with flying leads

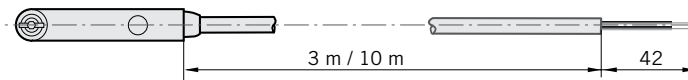

P8S-... cable with M8 rotatable

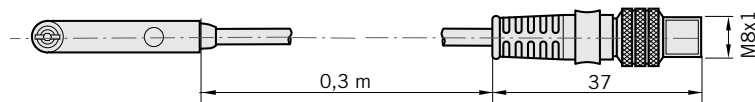

\* = Wrench Size

\*\* = Switching Point Reed

## Installation for Magnetic T-Slot Sensors

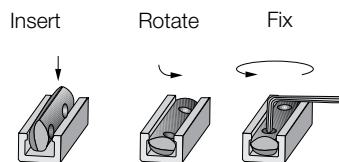

## Connection Cables suitable for cable chain

M8 Plug with 5 m cable	KL3186*
M8 Plug with 10 m cable	KL3217*
M8 Plug with 15 m cable	KL3216*

\* Detailed specifications for KL-Series on request.

